

davide guglielmi  
contemporary art of travel

#collectingmoments

Y A C H T  
*ISABELA II*  
GALAPAGOS ECUADOR





## Time-honored Galapagos Cruise Environment

Yacht Isabela II offers the perfect, intimate space for experiencing Darwin's islands in comfort. Explore the coast with your guides on our pangas, glass-bottom boat or kayaks, or get wet and snorkel. As on all our vessels, your groups can expect top facilities and equipment, delicious meals, and safe, stimulating expertly-planned expeditions on the islands.

## Boat Deck

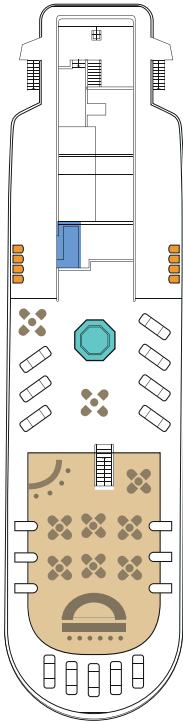

- Fitness Room
- Hot Tub
- Al Fresco Bar
- Life Rafts

## Cabin Deck

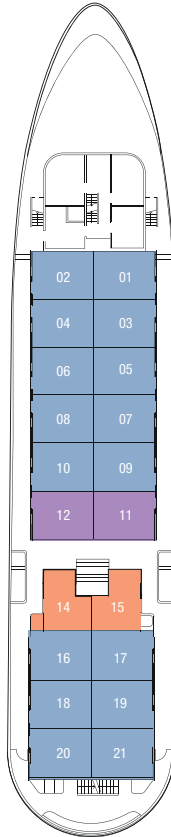

- Classic Cabin (16)
- Classic Family Cabin (2)
- Standard Cabin (2)

## Main Deck

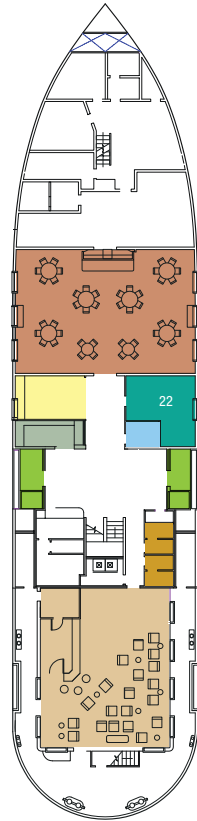

- Dining Room
- Computer Stations / Library
- Gift Shop
- Owner's Cabin (1)
- Infirmary
- Disembarkation Gangway
- Public Restrooms
- Bar Salon